

FIRST FLOOR GA  
SCALE 1:50 @ A1

FIRE STRATEGY LEGEND	
	TW LED RECESSED EMERGENCY DOWNLIGHT TO TRADING AREA / SURFACE MOUNTED TO BOH-NON MAINTAINED
	EMERGENCY LIGHTING EXIT SIGN - INTERNALLY ILLUMINATED (MAINTAINED)
	EMERGENCY LIGHTING EXIT SIGN - INTERNALLY ILLUMINATED (MAINTAINED)
	FIXED ALARM DEVICE DUAL OPTICAL & HEAT MULTI SENSOR
	FIXED ALARM DEVICE HEAT SENSOR - RATE OF RISE TYPE
	FIXED ALARM DEVICE SMOKE SENSOR - OPTICAL TYPE
	BUILT IN BASE SOUNDER TO HEAT AND SMOKE SENSORS
	FIXED ALARM DEVICE CALL POINT - MANUAL TYPE
	FIXED ALARM DEVICE - WARNING DEVICE VISUAL
	FIXED ALARM DEVICE - WARNING DEVICE AUDIBLE
	FIXED ALARM CONTROL PANEL - INTERLINKED WITH LANDLORDS PANEL
	FIRE EXTINGUISHER - CO2
	FIRE EXTINGUISHER - WATER TYPE
	FIRE EXTINGUISHER - AFFF
	FIRE EXTINGUISHER - FIRE BLANKET
	FIRE SAFETY SIGN - FIRE DOOR KEEP LOCKED SHUT
	FIRE SAFETY SIGN - DOOR TO BE OPEN DURING TRADING HOURS
	FIRE SAFETY SIGN - FIRE ESCAPE KEEP CLEAR
	FIRE SAFETY SIGN - FIRE EXIT
	FIRE SAFETY SIGN - STAFF ACTION NOTICE
	FD 30
	SC
	IS
	VP
	PB
	FRG
	DISABLED WC DISTRESS BEACON

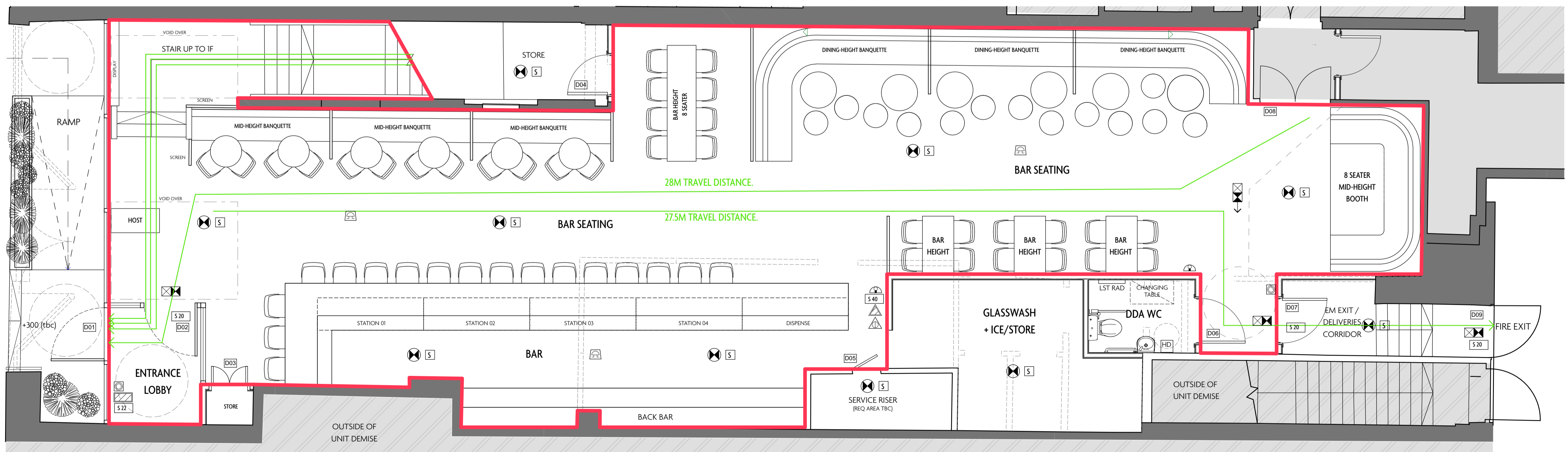

GROUND FLOOR GA  
SCALE 1:50 @ A1

LICENSING LEGEND:	
	AREA WHERE LICENSABLE ACTIVITIES WILL TAKE PLACE
THE POSITION OF THE FIRE EQUIPMENT IS CORRECT AT THE DATE OF SUBMISSION BUT MAY CHANGE FROM TIME TO TIME WITH APPROVAL OF THE FIRE OFFICER. ANY SEATING SHOWN ON THE PLANS WHICH IS UN-FIXED IS INDICATIVE AND MAY CHANGE FROM TIME TO TIME	
	EXTERNAL CAFE SEATING (LICENSED)
	TRAVEL DISTANCE TO EMERGENCY EXIT.

NOTES	REV	DATE	REASON	REV	DATE	REASON

**Macaulay Sinclair**

PROJECT Alchemist, Bristol PROJECT NO. **3700**  
 TITLE Licensing Plans  
 SCALE 1:50 at A1 / 1:100 at A3 DRAWING NO. **03/04**  
 DATE 24/03/17 DRAWN BY MP

**PRELIMINARY**